

1 VIGA BALDRAME PARTE 01  
1:200

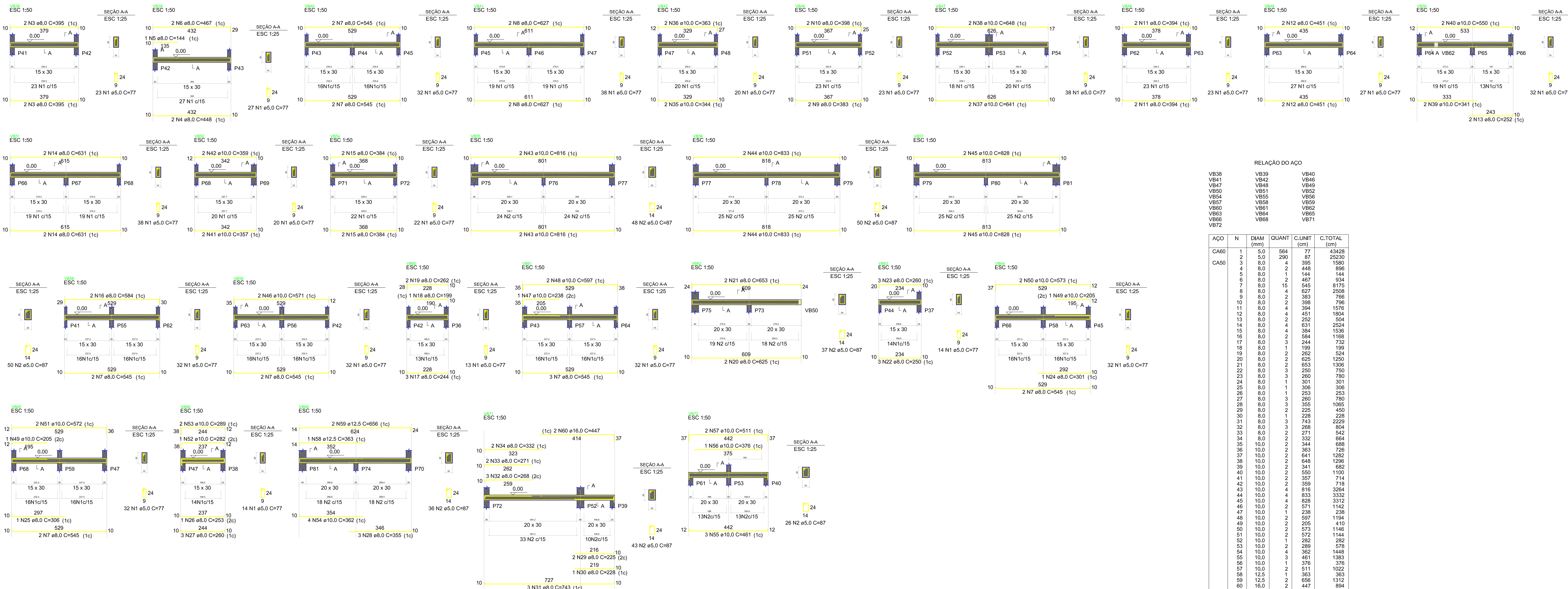

1 VIGA BALDRAME  
1:200

RELAÇÃO DO AÇO					
ACO	N	DIAM (mm)	QUANT	C.UNIT (cm)	C.TOTAL (cm)
CA50	1	5,0	77	5958	
	2	8,0	154	87	1338
	3	8,0	2	705	1510
	4	8,0	2	770	1540
	5	8,0	2	1135	2275
	6	8,0	2	1165	2330
	7	8,0	2	352	704
	8	8,0	2	404	808
	9	8,0	2	421	842
	10	8,0	2	231	462
	11	8,0	2	360	720
	12	8,0	2	215	430
	13	8,0	2	225	450
	14	8,0	2	412	824
	15	8,0	2	422	844
	16	8,0	2	730	1460
	17	8,0	2	740	1480
	18	8,0	2	344	688
	19	8,0	2	337	674
	20	8,0	2	347	694
	21	8,0	2	338	676
	22	8,0	2	358	716
	23	8,0	2	337	674
	24	8,0	2	284	568
	25	8,0	2	338	676
	26	8,0	2	346	692
	27	8,0	2	338	672
	28	8,0	2	610	1220
	29	8,0	2	600	1200
	30	8,0	2	595	1190
	31	8,0	2	605	1210
	32	8,0	2	281	562
	33	8,0	2	281	562
	34	8,0	2	606	1212
	35	8,0	2	616	1232
	36	8,0	2	334	668
	37	8,0	2	334	668
	38	8,0	2	284	568
	39	8,0	2	216	432
	40	8,0	2	240	480
	41	8,0	2	616	1232
	42	8,0	2	290	580
	43	8,0	2	275	550
	44	8,0	2	195	390
	45	8,0	2	239	478
	46	8,0	2	248	496
	47	8,0	2	280	560
	48	8,0	2	480	960
	49	10,0	2	403	806
	50	10,0	2	196	392
	51	10,0	2	454	908
	52	10,0	2	340	680
	53	10,0	2	370	740
	54	10,0	2	348	696
	55	10,0	2	404	808
	56	10,0	2	196	392
	57	10,0	2	452	904
	58	10,0	2	347	694
	59	10,0	2	389	778
	60	10,0	2	573	1146
	61	10,0	2	628	1256
	62	10,0	2	549	1098
	63	10,0	2	553	1106
	64	10,0	2	548	1096
	65	10,0	2	548	1096

RESUMO DO AÇO				
ACO	DIAM (mm)	C.TOTAL (m)	QUANT + 10% (Barras)	PESO + 10% (kg)
CA50	5,0	494,8	46	274,8
CA50	10,0	145,6	14	98,8
CA50	5,0	730	-	rodo (170 kg)
PESO TOTAL (kg)				
CA50				313,6
CA50				123,8
Volume de concreto (C-25) = 7,26 m³				
Área de forma = 116,0 m²				

RELAÇÃO DO AÇO					
ACO	N	DIAM (mm)	QUANT	C.UNIT (cm)	C.TOTAL (cm)
CA50	1	5,0	564	77	43428
	2	8,0	290	87	25320
	3	8,0	4	395	1580
	4	8,0	2	448	896
	5	8,0	2	144	288
	6	8,0	2	407	814
	7	8,0	15	545	8175
	8	8,0	2	627	1254
	9	8,0	2	383	766
	10	8,0	2	398	796
	11	8,0	4	394	1576
	12	8,0	2	451	902
	13	8,0	2	252	504
	14	8,0	2	631	1262
	15	8,0	4	384	1536
	16	8,0	2	594	1188
	17	8,0	3	244	732
	18	8,0	2	199	398
	19	8,0	2	262	524
	20	8,0	2	625	1250
	21	8,0	2	653	1306
	22	8,0	2	250	500
	23	8,0	3	260	780
	24	8,0	1	301	301
	25	8,0	1	306	306
	26	8,0	1	253	253
	27	8,0	3	260	780
	28	8,0	3	325	975
	29	8,0	2	225	450
	30	8,0	2	228	456
	31	8,0	3	743	2229
	32	8,0	3	289	867
	33	8,0	2	271	542
	34	8,0	2	332	664
	35	10,0	2	344	688
	36	10,0	2	363	726
	37	10,0	2	641	1282
	38	10,0	2	640	1280
	39	10,0	2	341	682
	40	10,0	2	650	1300
	41	10,0	2	357	714
	42	10,0	2	394	788
	43	10,0	4	816	3264
	44	10,0	1	833	1666
	45	10,0	4	828	3312
	46	10,0	2	271	542
	47	10,0	1	238	238
	48	10,0	2	597	1194
	49	10,0	2	295	590
	50	10,0	2	273	546
	51	10,0	2	572	1144
	52	10,0	2	262	524
	53	10,0	2	289	578
	54	10,0	4	362	1448
	55	10,0	3	461	1383
	56	10,0	1	376	376
	57	10,0	2	511	1022
	58	12,5	1	363	363
	59	12,5	2	511	1022
	60	10,0	2	658	1316
					894

RESUMO DO AÇO				
ACO	DIAM (mm)	C.TOTAL (m)	QUANT + 10% (Barras)	PESO + 10% (kg)
CA50	8,0	380,7	35	12 m
	10,0	274,8	29	12 m
	12,5	16,8	2	12 m
	16,0	8,3	1	12 m
CA50	5,0	686,6	-	rodo (170 kg)
PESO TOTAL (kg)				
CA50				384,9
CA50				116,4
Volume de concreto (C-25) = 7,16 m³				
Área de forma = 109,66 m²				

Construção e ampliação do 11º BPM

PRANCHA DE VIGAS BALDRAME

Endereço da Obra:

Av Presidente Vargas, 1410 Bairro Cristo Rei, São Miguel do Guaporé-RO

Zornameamento: Coef. de Aprov.: Taxa de Ocupação: Escala: Como Indicado Prancha: 1/1

Institucional

Governo do Estado de Rondônia

04.562.872/0001-02

Proprietário do Projeto:

Nome do Profissional:

Rosenberg Alves Fortes

CAUCREA nº: 18361 D-RO

Telefone: 69-99963-3741

E-mail: ENG.RAF011@GMAIL.COM

Projetista: Rosenberg Alves Fortes

Assinatura:

Rosenberg Alves Fortes  
Engenheiro Civil  
CREA 18361 D-RO

Nome do Profissional Responsável Técnico

CAU Nº / CREA Nº

Declara que a aprovação do projeto não implica no reconhecimento pela Prefeitura do direito de propriedade do terreno.

Espaço reservado para aprovação de projetos: